

Redox Probes (Smart Sensors)



RX-S-25
RX-S-25 EX

Parameters

- Cell voltage U_G
- OR potential U_H

RX-S-25	Zone Ex 2	Ex II 3G EEx nL IIC T6
RX-S-25 EX	Zone Ex 1	Ex II 2G EEx iama IIC T6



Redox probe installed in tilting bracket

Applications

- Drinking water
- Sewage pipe monitoring
- Control of the sewage inlet
- Leakage monitoring
- Influent (WWTP)
- Control of the denitrification process

Advantages

- Multiple connections with Züllig transmitters
- Cost-savings
- Rugged design (Swiss made)
- Optimal performance with Züllig transmitters
- Long Life

Submersion type

Features

- Low cost of ownership
- Fast response time and little drift
- Large variety of probe configurations
- User-friendly, low maintenance
- Temperature compensated
- Integrated microprocessor
- Connecting cable up to 300 m
- Fully encapsulated pre-amplifier
- Designed to be integrated into a series of different measurement points with Züllig transmitters
- Digital data transfer
- Bus system capable

State-of-the-art technology for continuous operation

User-friendly

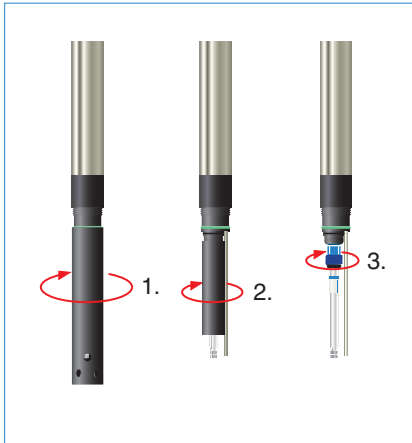

Easily changeable electrode

Ex Zone 2 RX-S-25

Specifications

Sensor	Pt
Measuring range	-1000...1000 mV
Resolution of measurement	1 mV
Ambient temperature	0...60 °C (inside of Ex-Zone 0...40 °C)
Pressure limit	max. 6 bar
Minimum conductivity	0,5 mS/m (equals 5µS/cm)
Certifications	CE II 3G EEx nL IIC T6
Classification Ex Zone	Group II, category 3, to use at Ex Zone 2
Application	in fluid media
Mounting depth	min. 45 mm

Electrical Data

Power Supply	24 VDC / 150 mA
Current output	ca. 12 mA
Signal type	digital
Cable	10 m (System 2000)
Plug	System 2000-S (optional)

Mechanical Data

Diameter	40 mm
Standard probe length:	
Type with end piece	340 mm
Type with hood	1500 mm
Special lengths (in interv. of 100 mm):	
Type with end piece	400...4000 mm
Type with hood	900...4000 mm
Quick clamp version	Tri-Clamp® (optional)

Material

Wetted Parts	PVC-U, PU, glass, PBT, platinum stainless steel DIN 1.4571 stainless steel DIN 1.4435
Sealing	NBR, FKM

Dimensions

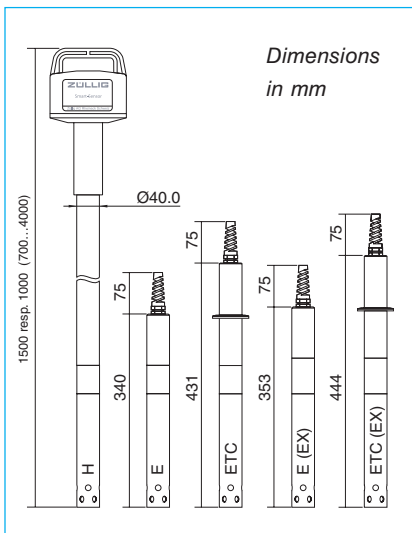

From left: Type H, Type E, Type ETC
Ex-Zone 1: Type E^{EX}, Typ ETC^{EX}

Ex Zone 1 RX-S-25 EX

Ambient temperature	0...60 °C (inside Zone Ex -20...40 °C)
Classifications	II 2G EEx iama IIC T6 CE 1254 QS 05 ATEX 2024
Application	Approved for Zone Ex 1 in fluid media
Power Supply	U _m = 30 VDC / I _m = 10 ADC
RS485	U _m = 4,2 VDC / I _m = 4,8 ADC
Length of type with end piece	353 mm

Additional data see RX-S-25

