

pH-Probes (Smart Sensors)



pH probe with bracket

Applications

- Raw wastewater
- Activated sludge
- Drinking water
- Lakes and rivers
- Sewers and storm water tank
- Channel spy
- Leakage monitoring
- Control and monitoring of industrial precipitation and pH neutralization plants
- Quality control of liquids
- Plating



Inlet of a WWTP

Advantages

- Multiple connections with Züllig transmitters
- Cost-savings
- Rugged design (Swiss made)
- Optimal performance with Züllig transmitters

PH1-S-25
PH2-S-25
PH2-S-25 EX

Parameters:

- pH value
- Potential
- Temperature (PH2.. type sensors)

PH1-S-25	Zone Ex 2	Ex II 3G EEx nL IIC T6
PH2-S-25	Zone Ex 2	Ex II 3G EEx nL IIC T6
PH2-S-25 EX	Zone Ex 1	Ex II 2G EEx iama IIC T6

Features

- Long term measurement
- Fast response
- Minimal drift
- User friendly, low maintenance
- PH2.. type sensors are temperature compensated
- Integrated microprocessor
- Connection cable up to 300 m
- Fully encapsulated pre-amplifier
- Optimal performance with Züllig transmitters
- Digital data transfer
- Bus system capable
- Mounting parts for easy installation
- easy calibration

State-of-the-art technology for continuous operation

User-friendly

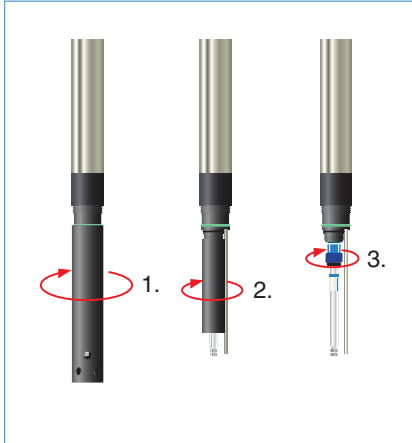

Easily changeable electrode

Ex Zone 2 PH1-S-25 and PH2-S-25

Specifications

Measuring range	0...14 pH
Sensitivity	0,01 pH
Temperature compensation	PH1-S-25 manual / PH2-S-25 autom.
Ambient temperature	0...60 °C (inside of Ex-Zone 0...40 °C)
Certifications	CE II 3G EEx nL IIC T6
Classification Ex Zone	Group II, category 3, to use at Ex Zone 2
Application	in fluid media
Pressure limit	max. 6 bar
Minimum conductivity	0,5 mS/m (equals 5µS/cm)
Mounting depth	min. 45 mm

Electrical Data

Power Supply	24 VDC / 150 mA
Current output	approx. 12 mA
Signal type	digital
Temperature element	PT1000 (not PH1-S-25)
Cable	10 m (Züllig System 2000)
Plug	System 2000-S (optional)

Mechanical Data

Diameter	40 mm
<i>Standard probe length:</i>	
Type with end piece	340 mm
Type with hood	1000 mm
<i>Special lengths (intervals of 100 mm):</i>	
Type with end piece	400...4000 mm
Type with hood	900...4000 mm
Quick change version	Tri-Clamp® (optional)

Material

Wetted Parts	PVC-U, PU Stainless steel DIN 1.4571 Stainless steel DIN 1.4435
Sealing	NBR, FKM, silicone or PTFE

Dimensions

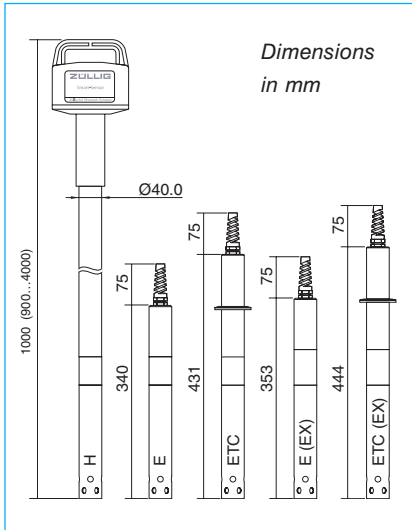

From left: Type H, Type E, Type ETC
Ex-Zone 1: Type E^{EX}, Typ ETC^{EX}

Ex Zone 1 PH2-S-25 EX

Ambient temperature	0...60 °C (inside Zone Ex -20...40 °C)
Certifications	II 2G EEx iama IIC T6 CE 1254 QS 05 ATEX 2024
Application	Approved for Zone Ex 1 in fluid media
Power Supply	U _m = 30 VDC / I _m = 10 ADC
RS485	U _m = 4,2 VDC / I _m = 4,8 ADC
Length of type with end piece	353 mm

Additional data see PH2-S-25

